

A Map of the Estate of Thomas Lewis White Esq^r. situate in the Parish of Ferns and County of Wexford, and referred to by the annexed Certificate

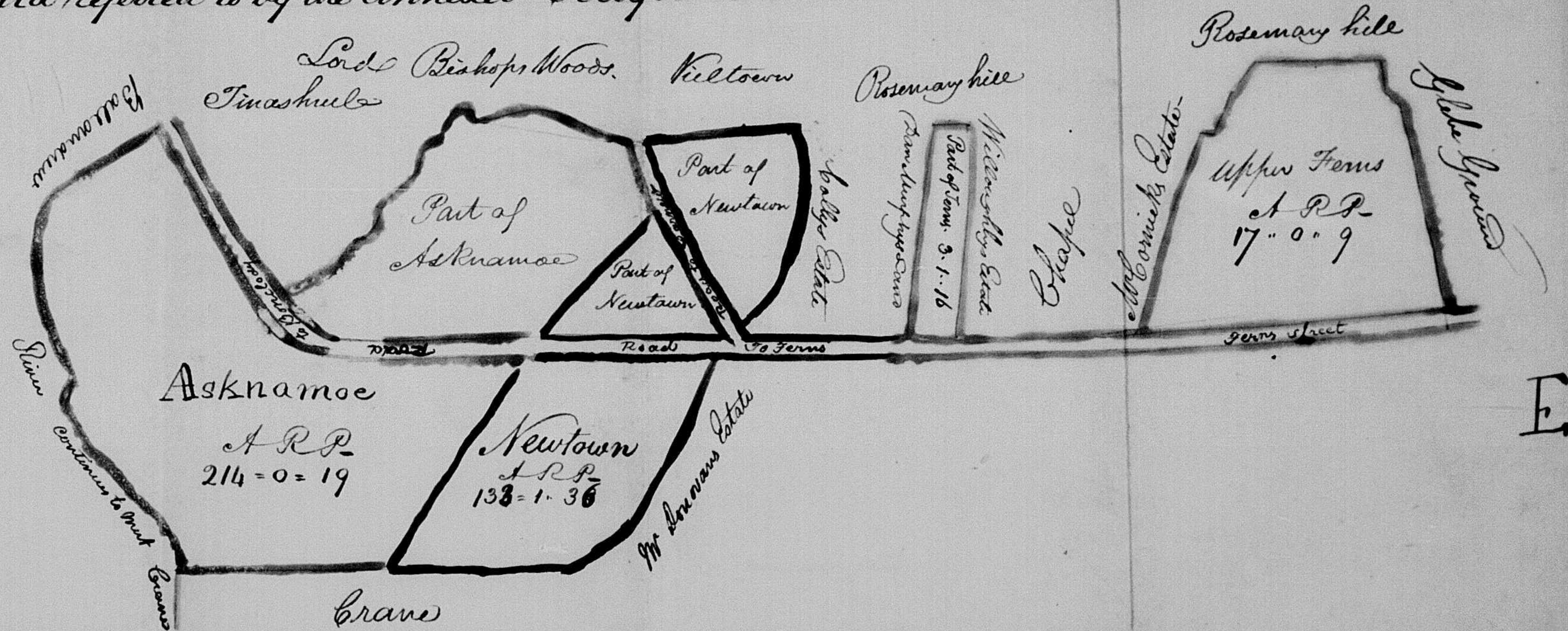

Upper Ferns	A.R.P.	17-0-09
Grass Field		3-1-16
Asknamoe	A.R.P.	214-0-19
Newtown	A.R.P.	133-1-36
Total		<u>368-0-2</u>

Plantation Measure including all Roads

S